

Google Earth
 Imagery Date: 6/12/2019 49°08'35.11" N 121°56'33.38" W elev. 0 ft eye alt. 700 ft

LEGEND: Advanced Warning Sign Closure Area Detector Traffic Control Person	UNIVERSAL TRAFFIC MANAGEMENT UNIVERSAL GROUP TRAFFIC MANAGEMENT DIVISION 14000 140th Ave NW ALBUQUERQUE, NM 87112	REVISIONS: <table border="1"> <thead> <tr> <th>DATE</th> <th>DETAILS</th> </tr> </thead> <tbody> <tr><td> </td><td> </td></tr> <tr><td> </td><td> </td></tr> <tr><td> </td><td> </td></tr> <tr><td> </td><td> </td></tr> <tr><td> </td><td> </td></tr> <tr><td> </td><td> </td></tr> <tr><td> </td><td> </td></tr> <tr><td> </td><td> </td></tr> <tr><td> </td><td> </td></tr> </tbody> </table>	DATE	DETAILS																			NOTES: 1. Dates: 2. Hours of Operation: 3. Duration: 2 Days 4. Traffic Plan based on 50 km/h speed zone 5. TCPs to assist pedestrian and cyclists as required 6. TCPs to accommodate local traffic as required in and out of residences 7. TCPs to accommodate emergency vehicles as required 8. Existing lane alignment to be reinstated at the end of each shift 9. Traffic specifications based on the Traffic Management Manual for Work on Roadways (2020)	TELUS NETWORK NO. TRAFFIC WORKZONE BASIC CONTRACT DATE STARTED TO BE MONITORED: N/A TRAFFIC CONTROL PERSON: N/A	TELUS - FOCUS COMMUNICATIONS CITY OF CHILLIWACK: CHILLIWACK RIVER RD PROJECT NO.: 947533344 DRAWING NO.: DWG#11A DATE: 01.05.2021 SCALE: 1:1000
			DATE	DETAILS																					

5/12/2019
 Imagery Date: 6/12/2019

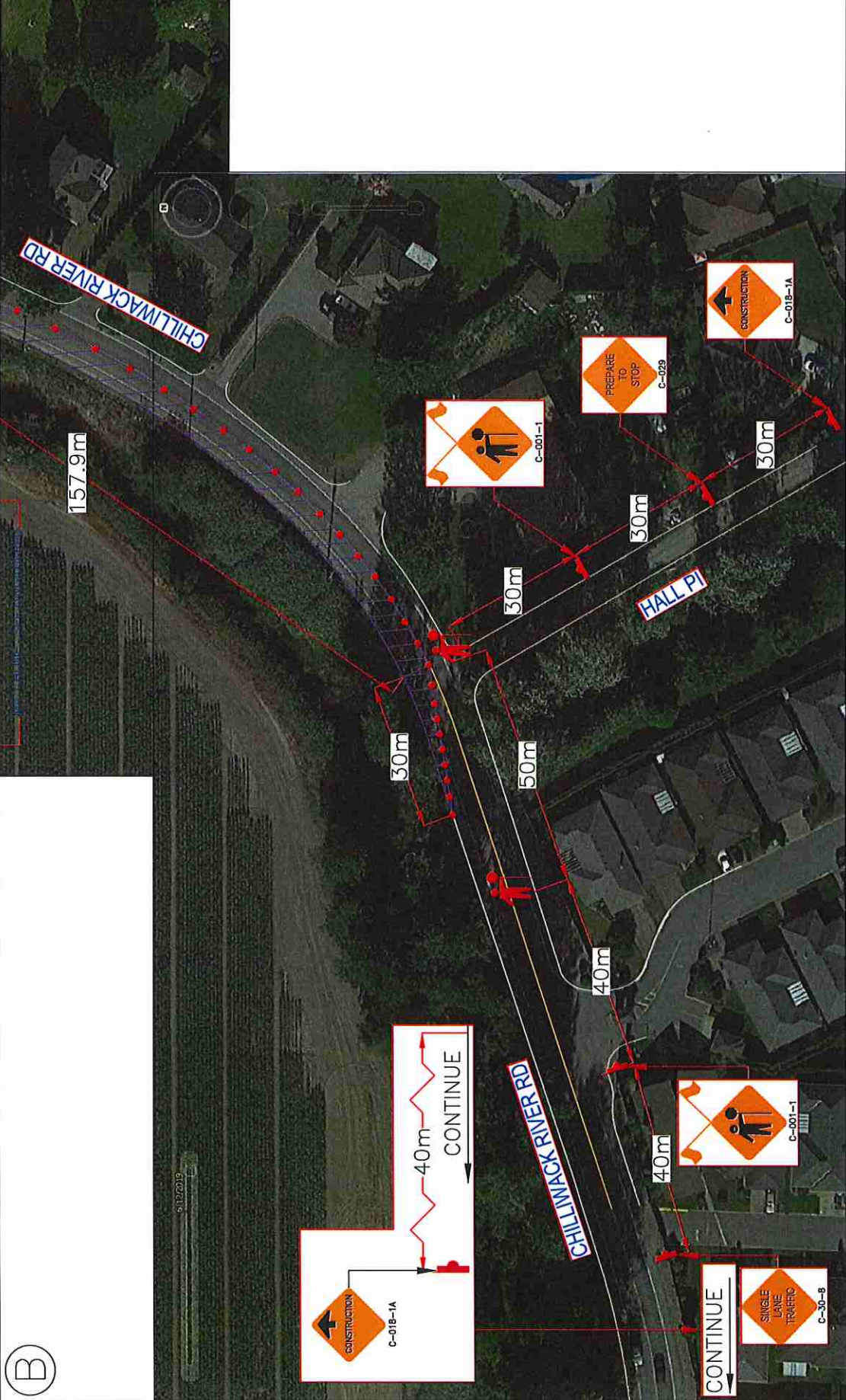

LEGEND: Advanced Warning Sign Closure Area Delimiter Traffic Control Person		REVISIONS: <table border="1"> <thead> <tr> <th>DATE</th> <th>DETAILS</th> </tr> </thead> <tbody> <tr> <td> </td> <td> </td> </tr> <tr> <td> </td> <td> </td> </tr> <tr> <td> </td> <td> </td> </tr> <tr> <td> </td> <td> </td> </tr> </tbody> </table>		DATE	DETAILS								
DATE	DETAILS												
NOTES: 1. Dates: 2. Hours of Operation: 3. Duration: 2 Days 4. Traffic Plan based on 50 km/h speed zone 5. TCPs to assist pedestrian and cyclists as required 6. TCPs to accommodate local traffic as required in and out of residences 7. TCPs to accommodate emergency vehicles as required 8. Existing lane alignment to be reinstated at the end of each shift 9. Traffic specifications based on the Traffic Management Manual for Work on Roadways (2020)		TELUS NETWORK WA: TRAFFIC CONTROL PERSON: TRAFFIC CONTROL PLAN: CHILLIWACK RIVER RD DATE: 01.05.2021 SCALE: 1:500 DRAWING NO: 947538344 PROJECT NO: 00 OBI:											
TELUS NETWORK WA: TRAFFIC CONTROL PERSON: TRAFFIC CONTROL PLAN: CHILLIWACK RIVER RD DATE: 01.05.2021 SCALE: 1:500 DRAWING NO: 947538344 PROJECT NO: 00 OBI:		TELUS - FOCUS COMMUNICATIONS CITY OF CHILLIWACK: CHILLIWACK RIVER RD DRAWING NO: 947538344 PROJECT NO: 00 OBI:											